

Special Project

Project One: Tiny House

June Lee

TRANSFORMATION



Space Saving by **Transforming Furniture**

Illusion by Using **Light Colors**

Maximizing the Use of Natural Light Through **Windows**

Minimizing Unnecessary Elements by **Simple Design**

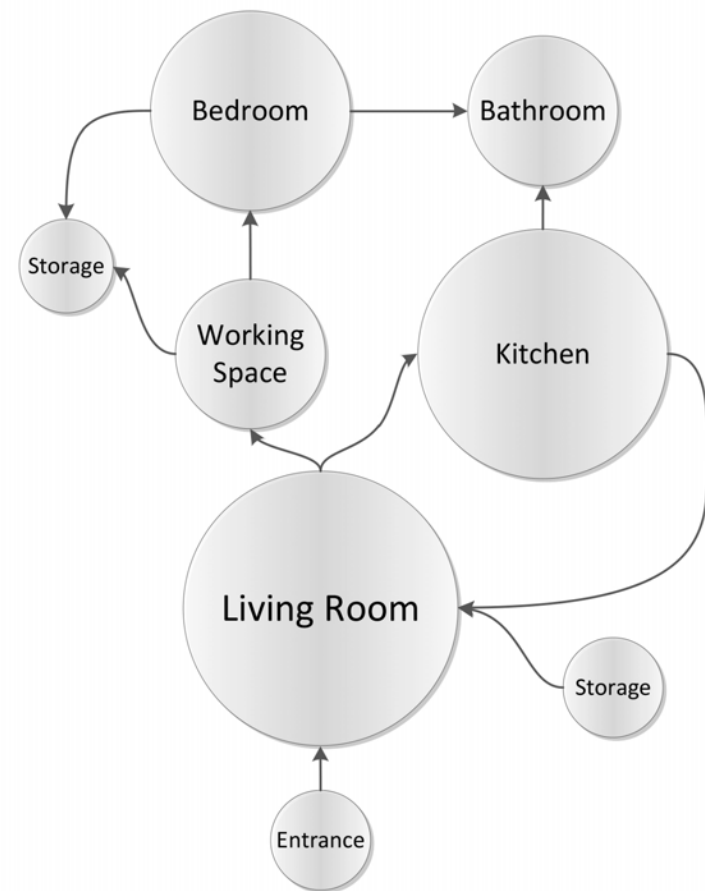

Kitchen/ Living Room 1.

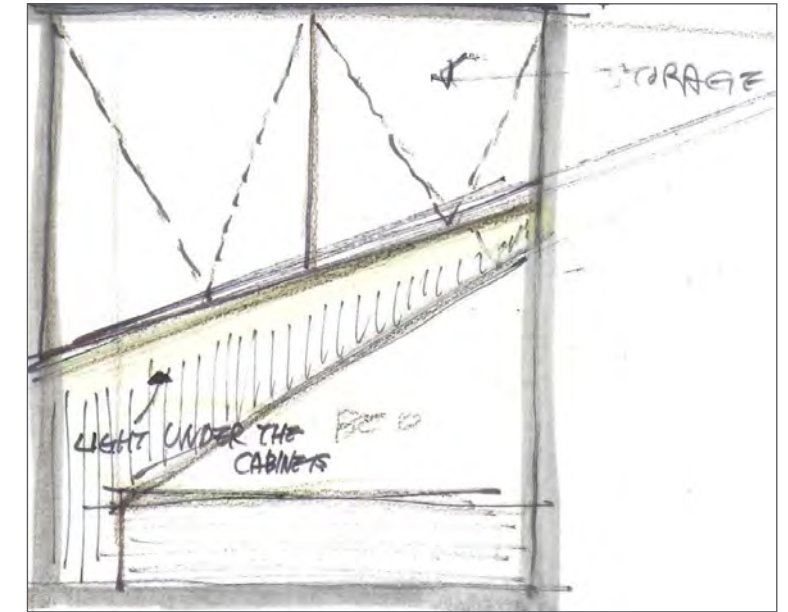

Bedroom

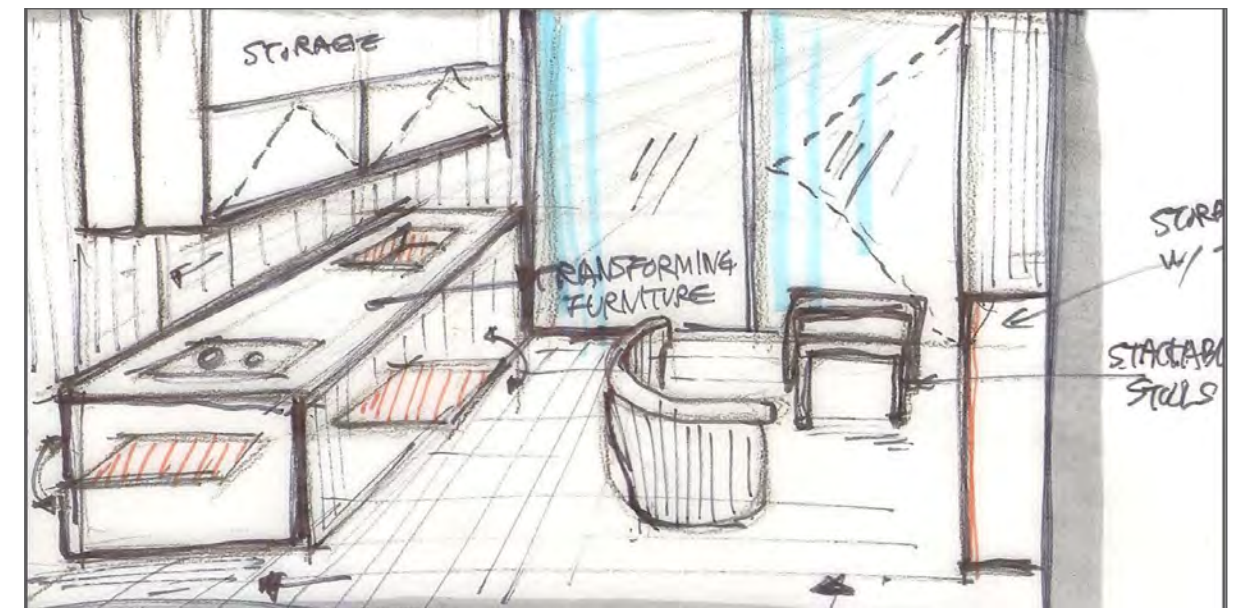

Kitchen/ Living Room 2.

First Floor Plan

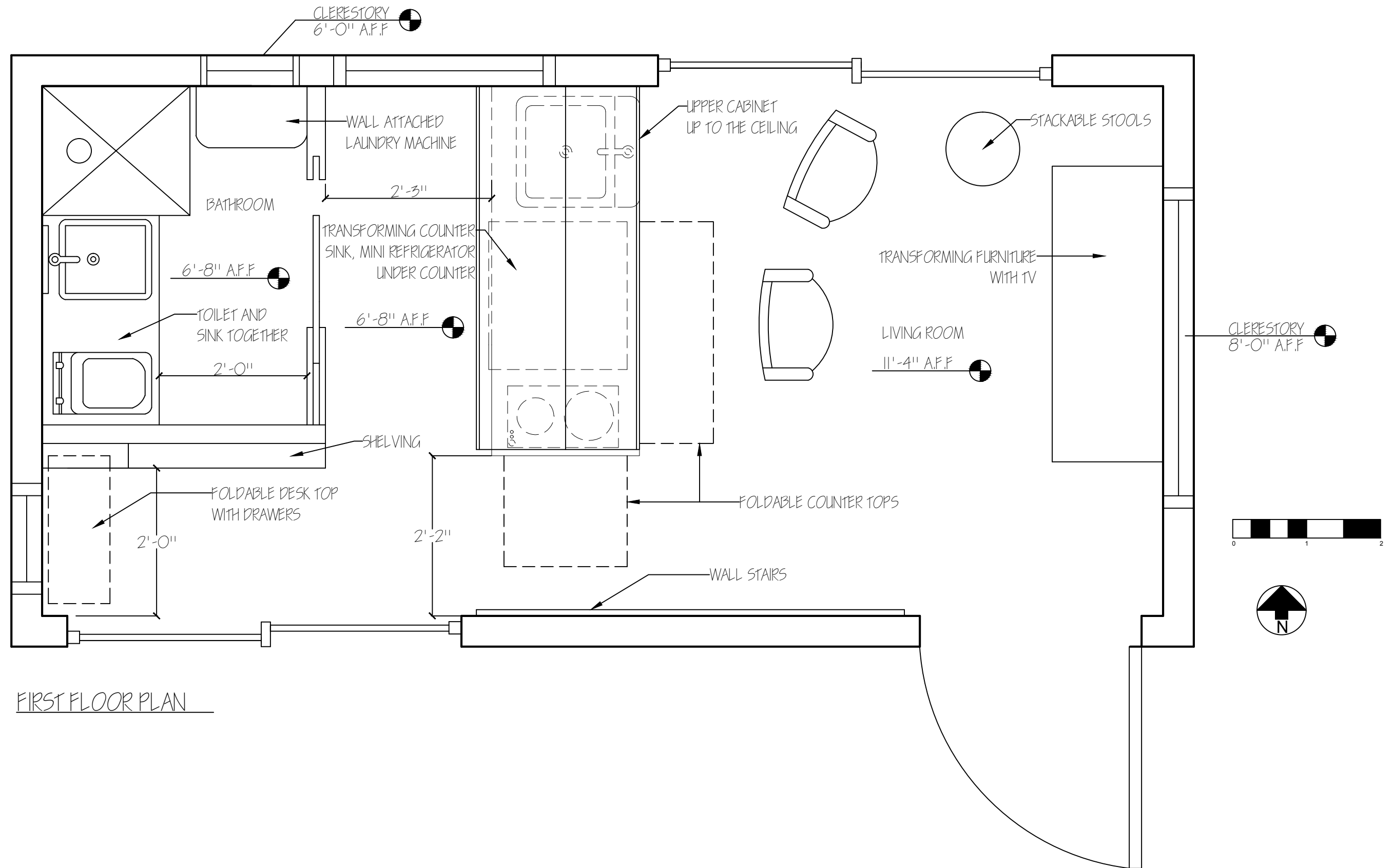

FIRST FLOOR PLAN

Loft Floor Plan

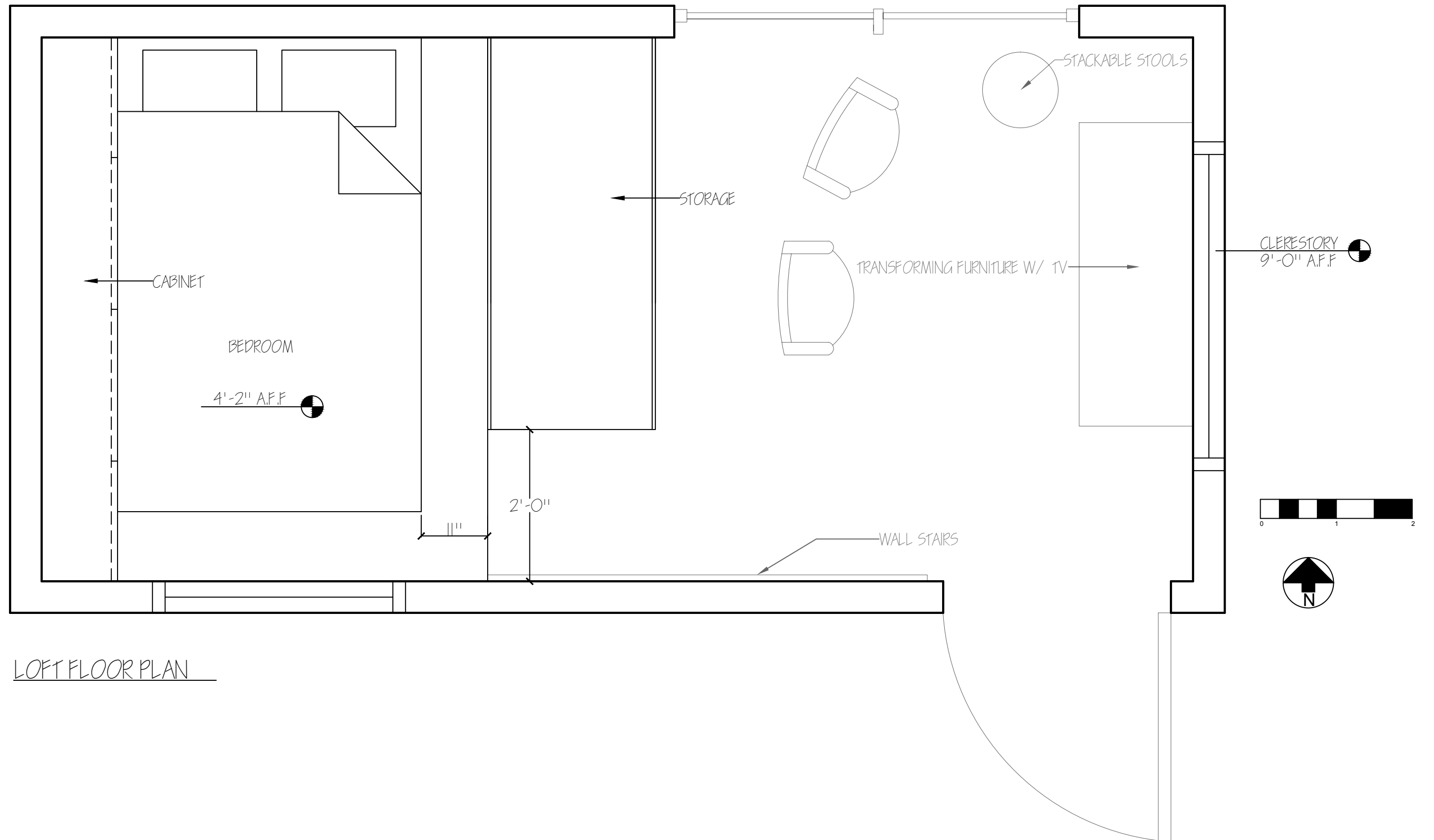

LOFT FLOOR PLAN

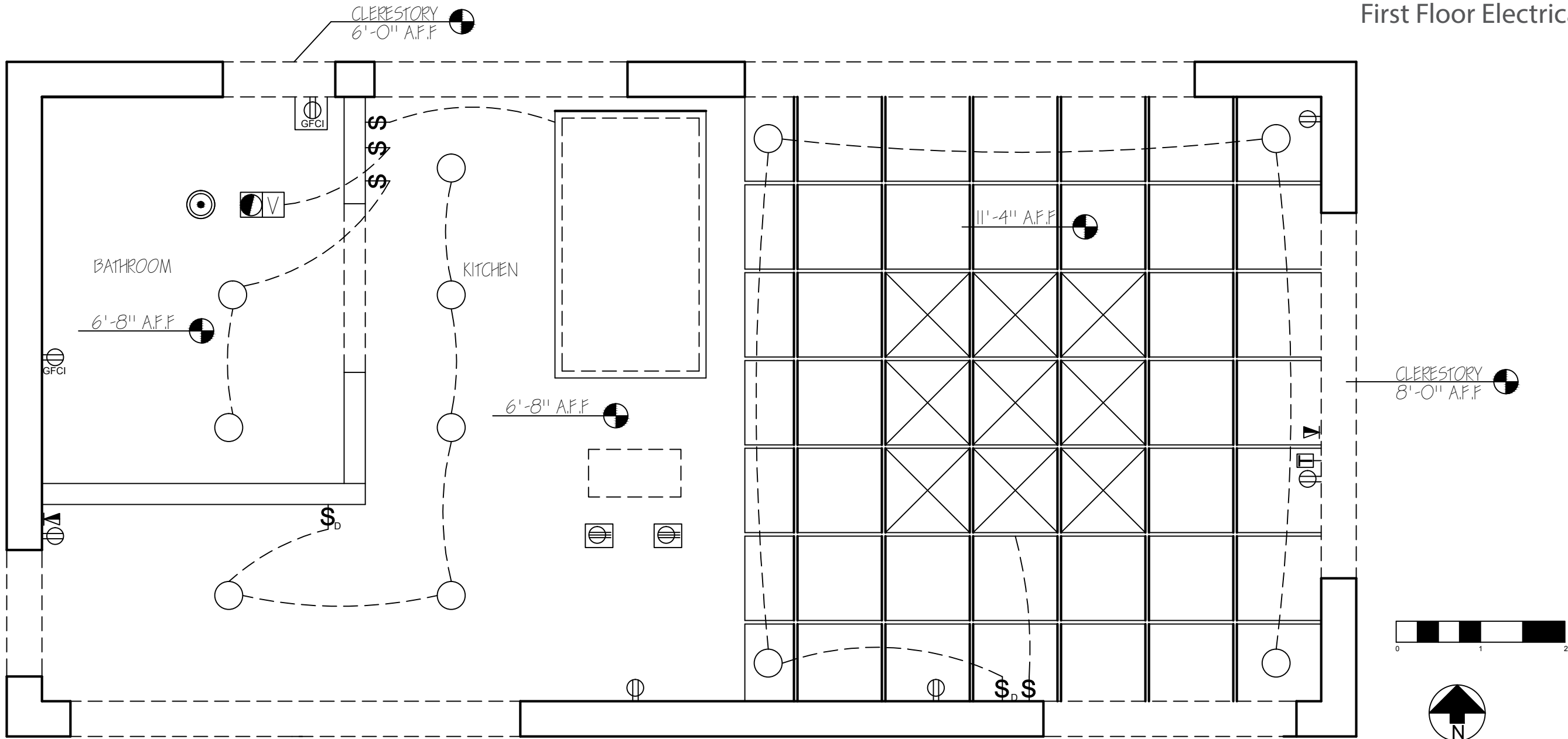

FIRST FLOOR ELECTRICAL PLAN

LEGEND					
	4" RECESSED DOWN LIGHT		SINGLE POLE SWITCH		110 VOLT OUTLET WITH GFCI
	COVE LIGHT		THREE-WAY SWITCH		110 VOLT GFCI WITH COVER
	W&W RECESSED CEILING LIGHT		SINGLE POLE SWITCH WITH DIMMER		110 VOLT STANDARD OUTLET
	FAN AND VENTILATION		THREE-WAY SWITCH DIMMER		220 VOLT STANDARD OUTLET ON FLOOR
	KITCHEN VENTILATION		TELEPHONE AND DATA JACK		SMOKE DETECTOR
			CABLE HOOK-UP		

Loft Floor Electrical Plan

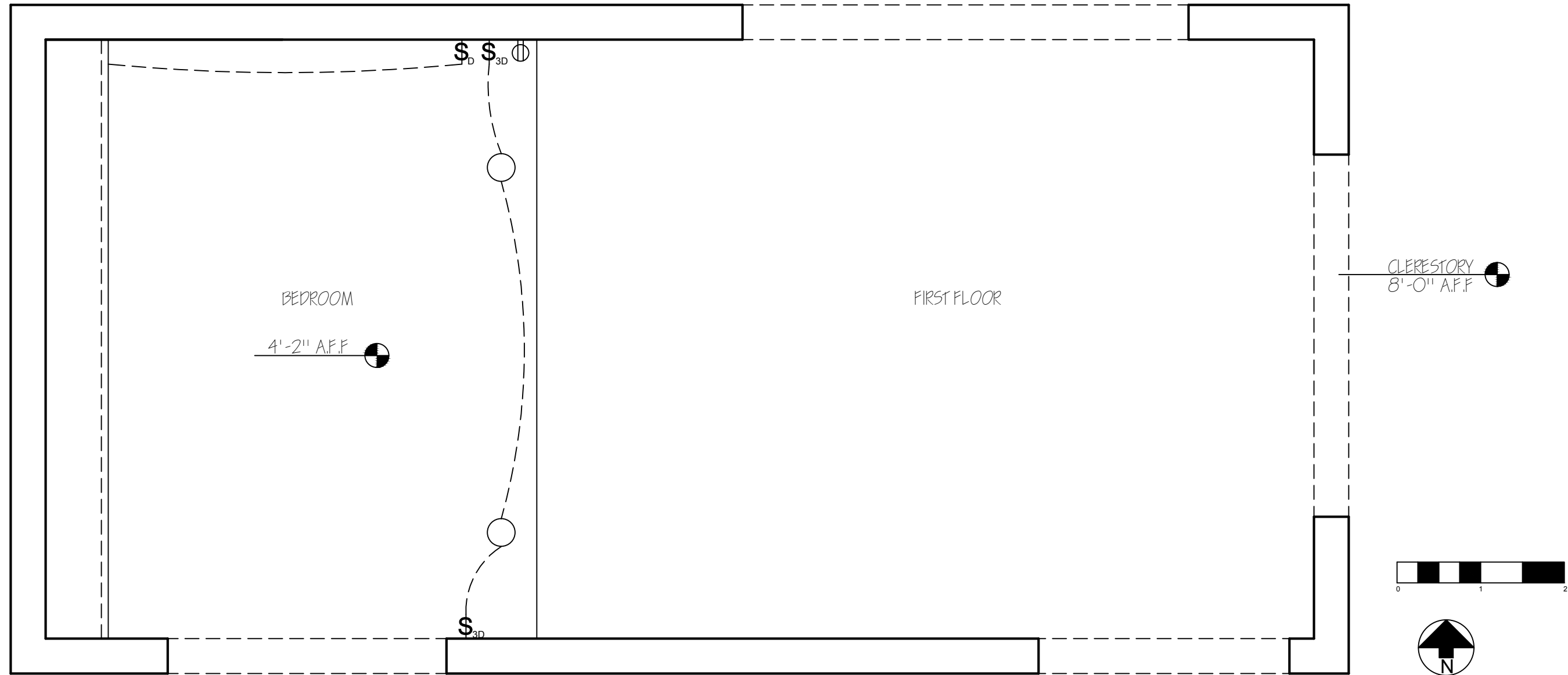

LOFT FLOOR ELECTRICAL

LEGEND		
	4" RECESSED DOWN LIGHT	SINGLE POLE SWITCH
	COVE LIGHT	THREE-WAY SWITCH
	W&V RECESSED CEILING LIGHT	SINGLE POLE SWITCH WITH DIMMER
	FAN AND VENTILATION	THREE-WAY SWITCH DIMMER
	KITCHEN VENTILATION	TELEPHONE AND DATA JACK
		GFCI
		GFCI WITH COVER
		110 VOLT OUTLET
		220 VOLT OUTLET ON FLOOR
		SMOKE DETECTOR
		CABLE HOOK-UP

Exterior Elevation Views

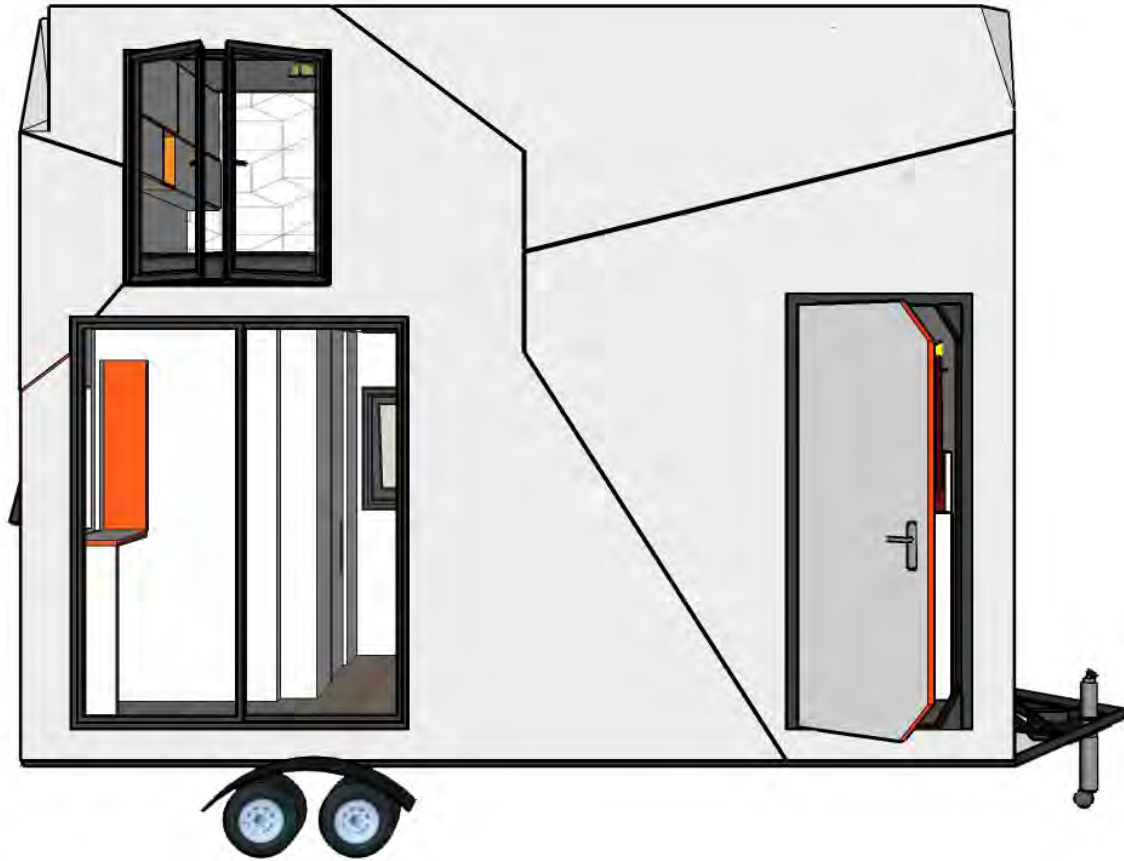

South Elevation View

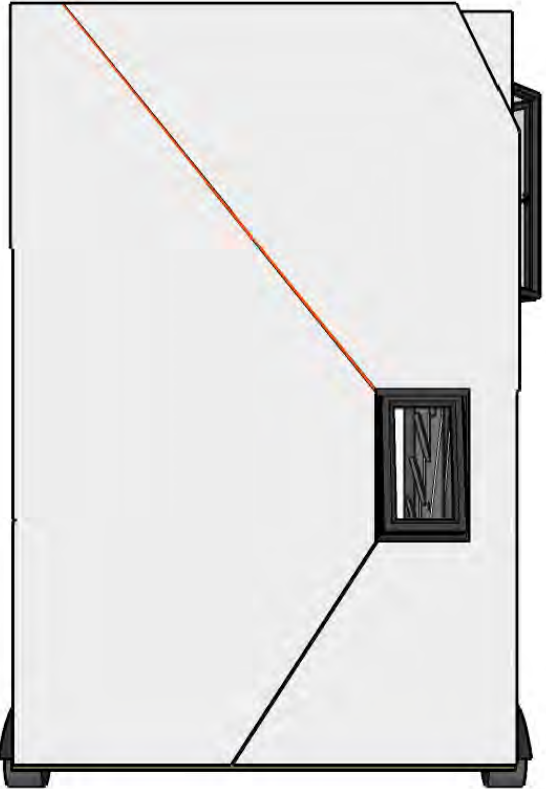

West Elevation View

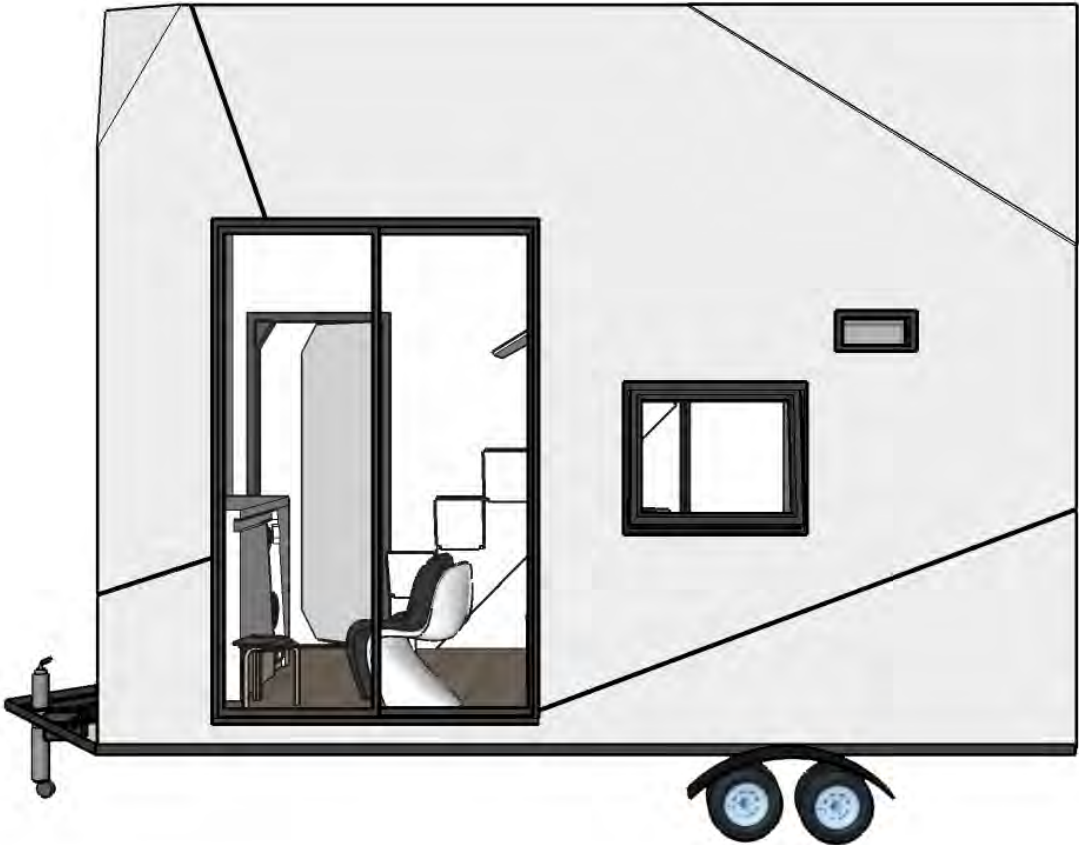

North Elevation View

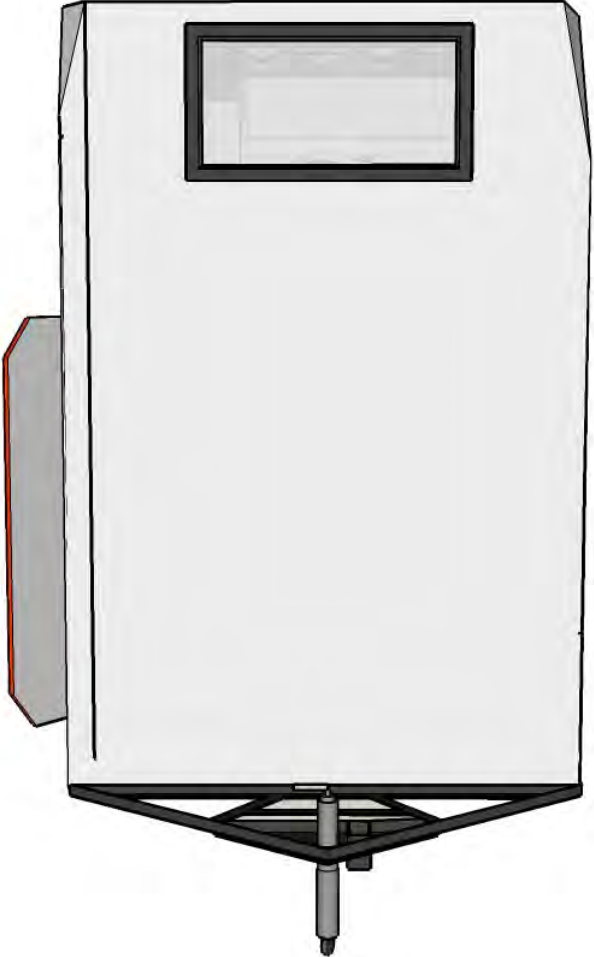

East Elevation View



Boxetti_Transforming Furniture

The series of modules are capable of transforming into a range of furnishings

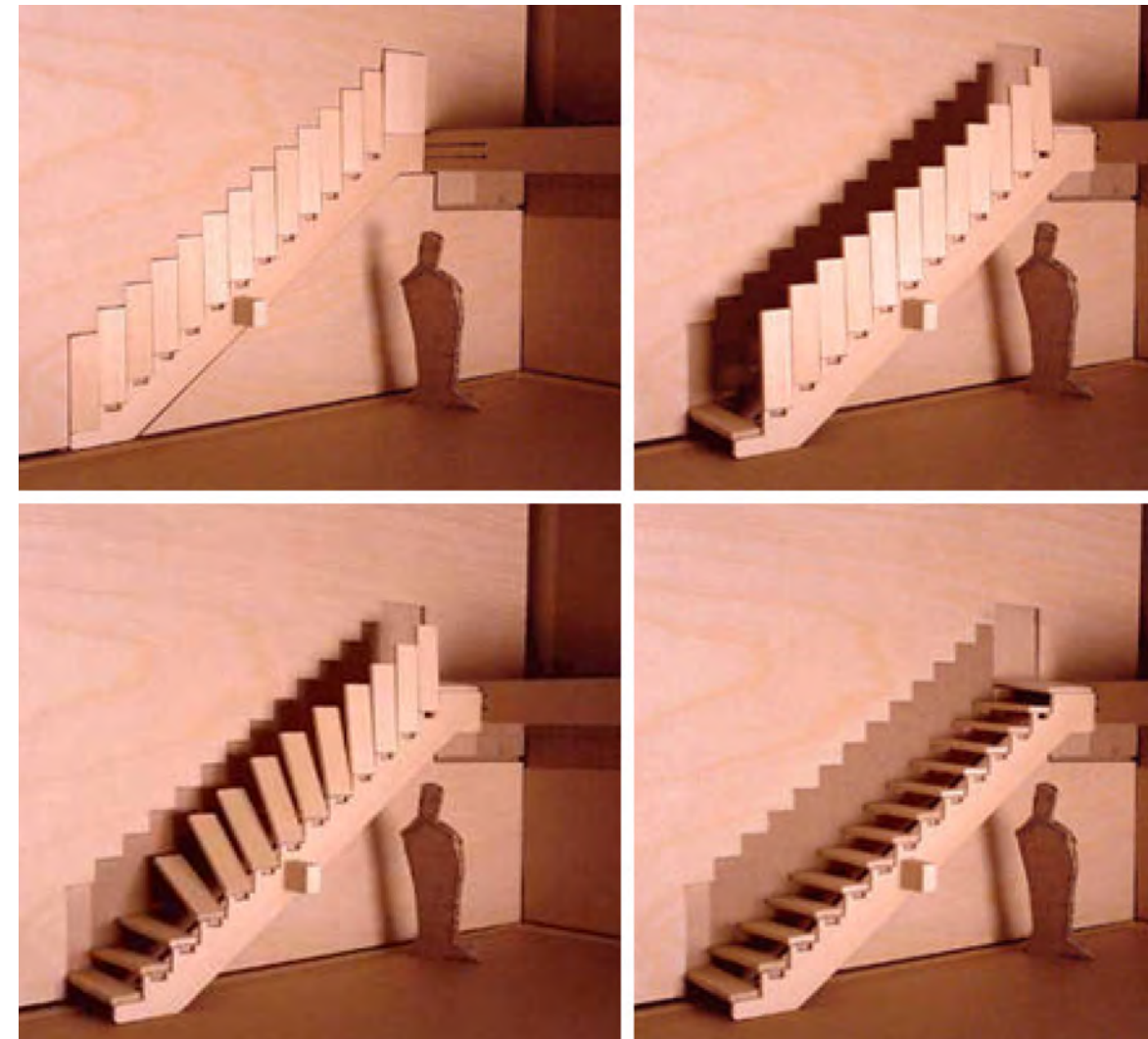

Aaron Thang's Disappearing Stairs

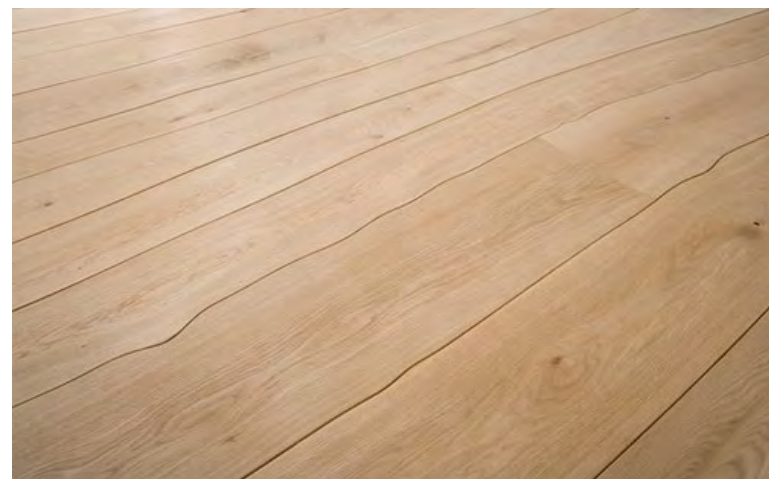

Curved Length Wood Flooring

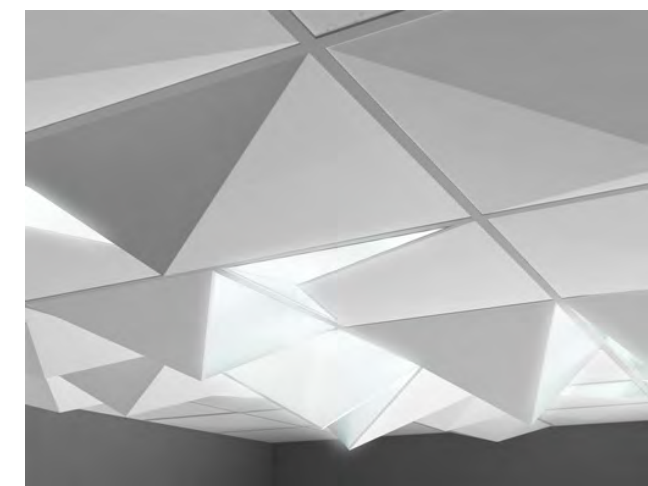

W&W Recessed Ceiling Light

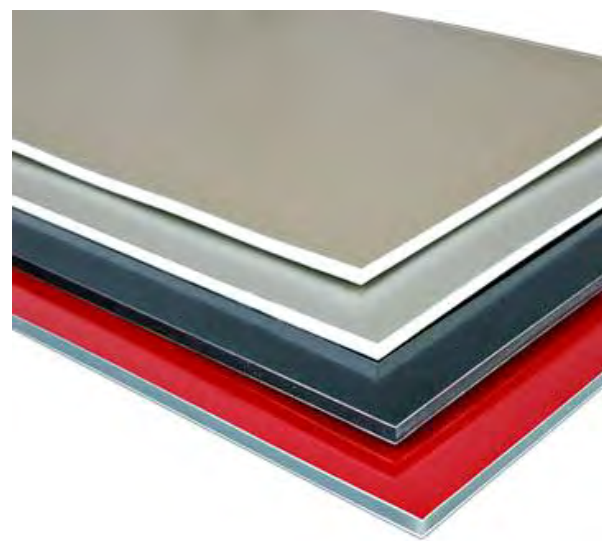

Exterior Finish; Aluminum Plastic Composite Panel

Interior Rendering 1.







Interior Rendering 4- Bedroom.



Exterior View

